

SIGNALING / WARNING TRAILERS

MODELS: P 4000

P 5000

P 6000

Signaling boards

ISO 9001:2015

ISO 27001:2013

ISO 14001:2015

ISO 39001:2012

ISO 50001:201

*Homologated according to
UN regulations 48, 55, 58.*

EN 12899-1:2007

ISO 45001:2018

ISO 22301:2019

EN 1090-1

EN 1090-2

EN ISO 3834-2



P 4000 - S

COUPLING CLAW

RIGID TOW BAR

ELECTRIC LIFT

**SIGNALING TRAILER
P 4000**

P 4000 - O

TOW EYE

ADJUSTABLE
TOW BAR

ELECTRIC LIFT



*Homologated according to
UN regulations 48, 55, 58.*

TECHNICAL SPECIFICATIONS

Trailer dimensions:

In working position (H × W × L): 3065 × 2030 × **3740 mm** - coupling claw

In working position (H × W × L): 3065 × 2030 × **3860 mm** - towing eye

In transport position (H × W × L): 1730 × 2030 × 3740 mm - coupling claw

In transport position (H × W × L): 1730 × 2030 × 3860 mm - towing eye

Usable box area: 1680x1390x340mm

Weight: 420 kg

Axle load: 370 kg, load on towing vehicle: 50 kg

Power supply : Battery – 100 Ah (for the version with an electric actuator: two 55 Ah batteries) with the option of power supply from the towing vehicle; connection – 7-pin plug.

From mains power – the trailer includes the following equipment: mains socket, battery charger, power cable, and charging activation switch.

Folding platform: with folding of the trailer's upper section into transport position via "Linak" electric actuator

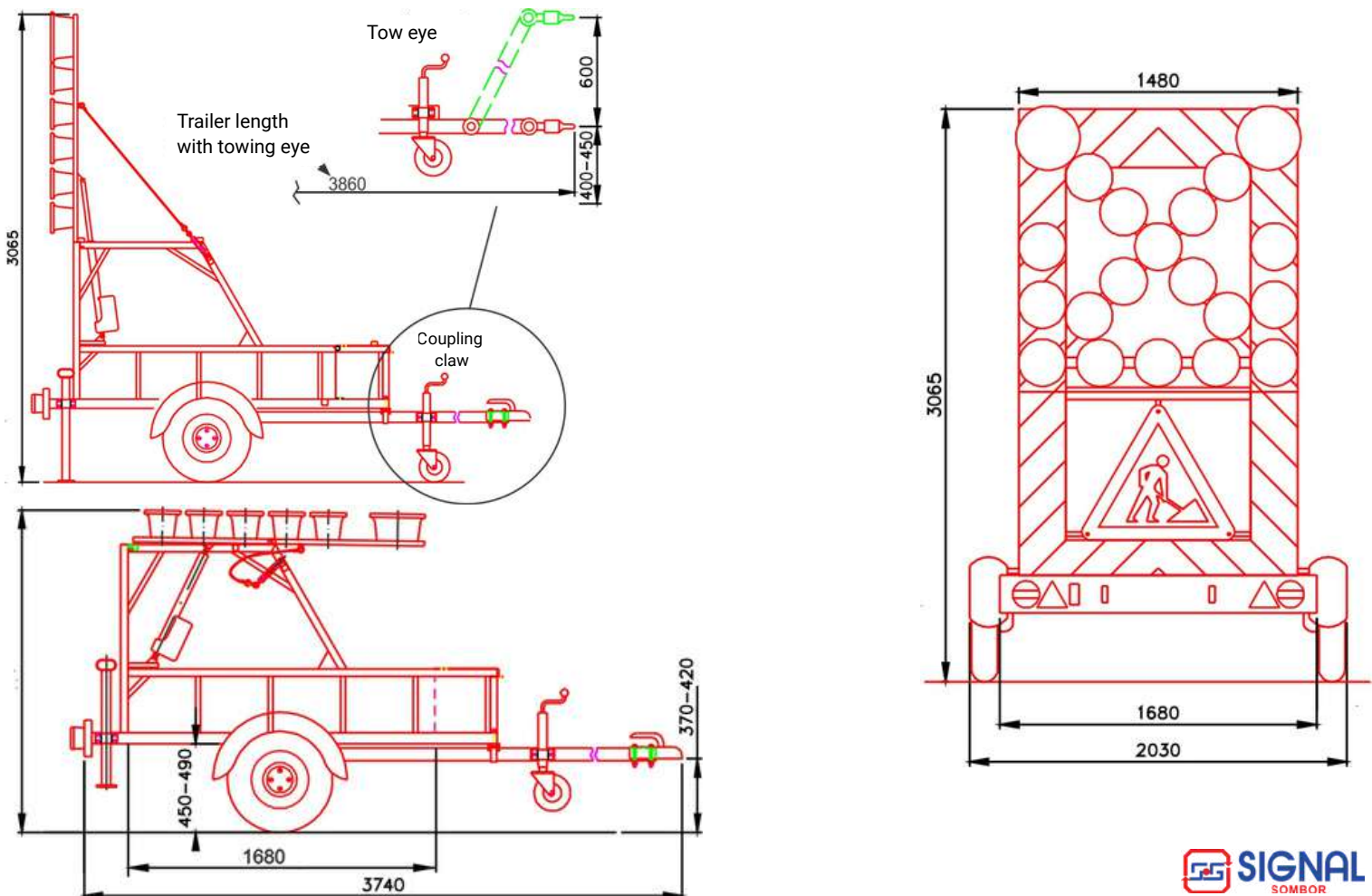



P 5000 - S

COUPLING CLAW

RIGID TOW BAR

ELECTRIC LIFT

**SIGNALING TRAILER
P 5000**

P 5000 - 0

TOW EYE

**ADJUSTABLE
TOW BAR**

ELECTRIC LIFT



*Homologated according to
UN regulations 48, 55, 58.*

TECHNICAL SPECIFICATIONS

Trailer dimensions:

In working position (H × W × L): 3583 × 2030 × **3400 mm** - coupling claw

In working position (H × W × L): 3583 × 2030 × **3520 mm** - towing eye

In transport position (H × W × L): 1730 × 2030 × 3400 mm - coupling claw

In transport position (H × W × L): 1730 × 2030 × 3520 mm - towing eye

Usable box area: 1680x1390x340mm

Weight: 420 kg

Power supply : **Two** 180 Ah batteries and the option to power from:
Towing vehicle – via a 7-pin connector

Mains power – the trailer includes the following equipment:
mains socket, battery charger, power cable, and a charging activation switch.

Folding platform: with folding of the trailer's upper section into transport position via "Linak" electric actuator

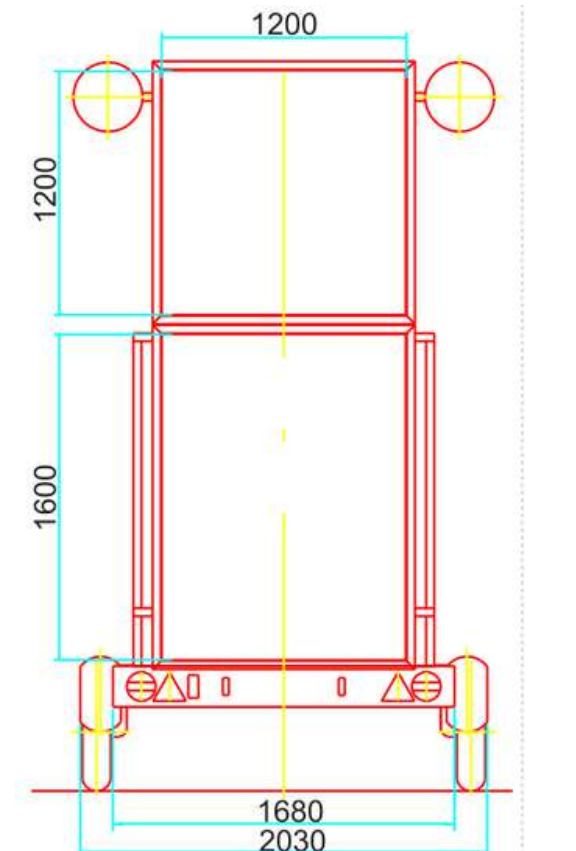
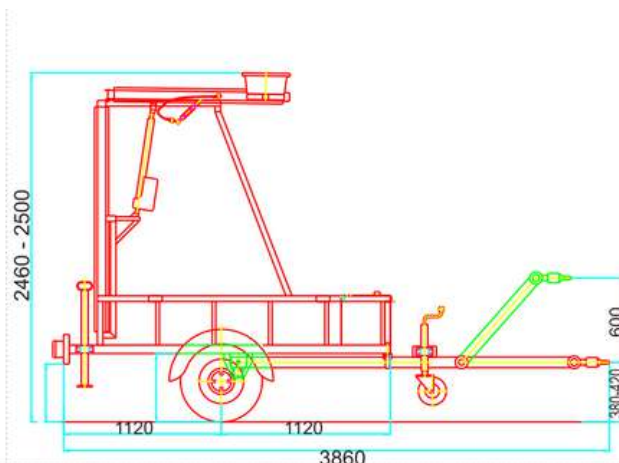
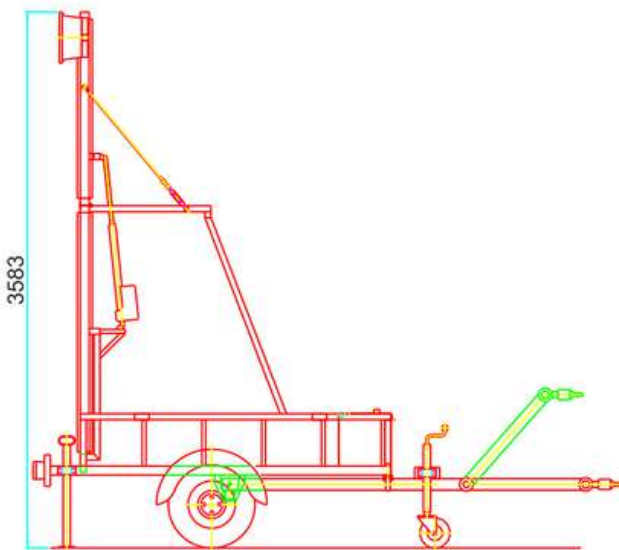



P 6000 - S
COUPLING CLAW
RIGID TOW BAR
ELECTRIC LIFT

**SIGNALING TRAILER
P 6000**

P 6000 - O
TOW EYE
ADJUSTABLE
TOW BAR
ELECTRIC LIFT



*Homologated according to
UN regulations 48, 55, 58.*

TECHNICAL SPECIFICATIONS

Trailer dimensions:

In working position (H × W × L): 4148 × 2030 × **3740 mm** - coupling claw

In working position (H × W × L): 4148 × 2030 × **3860 mm** - towing eye

In transport position (H × W × L): 1730 × 2030 × 3740 mm - coupling claw

In transport position (H × W × L): 1730 × 2030 × 3860 mm - towing eye

Usable box area: 1680x1390x340mm

Weight: 480 kg - coupling claw, 505 kg - tow eye

Load on a towing vehicle 60 kg

Power: supply Battery – 100 Ah (for the version with an electric actuator: two 55 Ah batteries) with the option of power supply from the **towing vehicle**; connection – 7-pin plug.

From mains power – the trailer includes the following equipment: mains socket, battery charger, power cable, and charging activation switch.

Folding platform: with folding of the trailer's upper section into transport position via "Linak" electric actuator

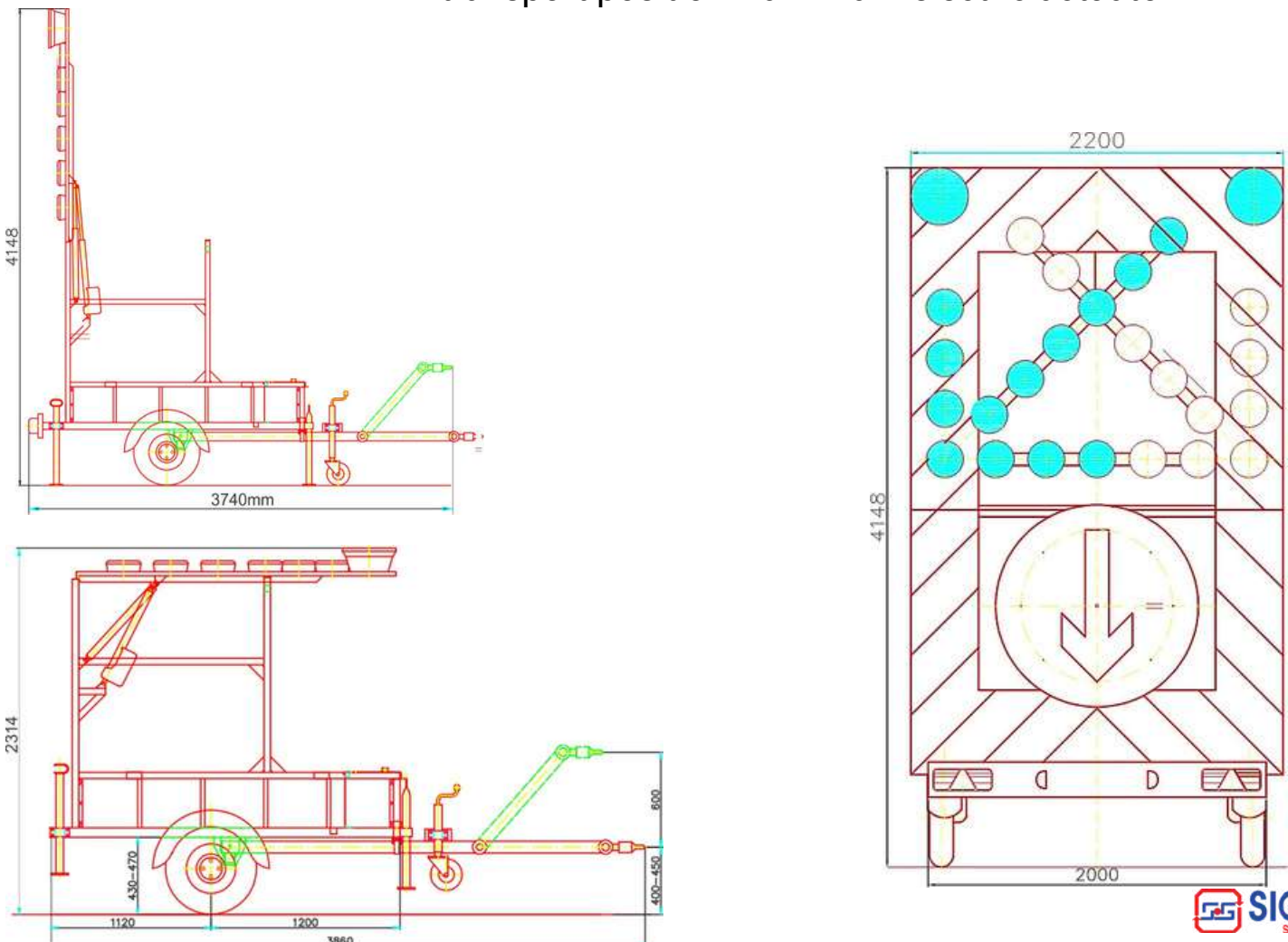



SIGNALING BOARDS



*Homologated according to
UN regulations 48, 55, 58.*

The signaling board is designed for transport on a cargo vehicle to the worksite, where it is unloaded and positioned in front of the work area.

The board is equipped with wheels on its frame to facilitate handling and positioning.

It can be fixed to the cargo area of the vehicle and thereby put into operational use.

The lighting unit is powered by built-in batteries, which are recharged from the mains via an integrated charger.

