

toolflex®

Ergonomic

Efficient

Hygienic

Product Catalogue

The Toolflex System is a range of simple, flexible tool organizers that helps users effectively organize, efficiently store and quickly access a wide variety of tools of different sizes, shapes and contours.





Ergonomic



55% of all cleaning professionals suffer from back or neck pain.*

Storage in motion

No carrying tools between steps – the tools you need are readily available and can be safely transported on the cleaning cart.

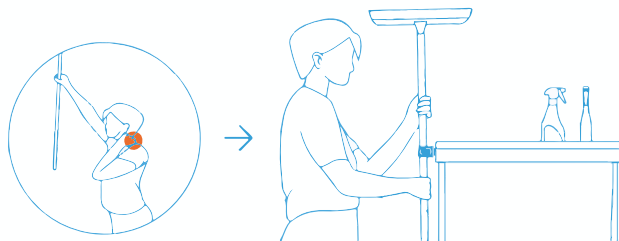
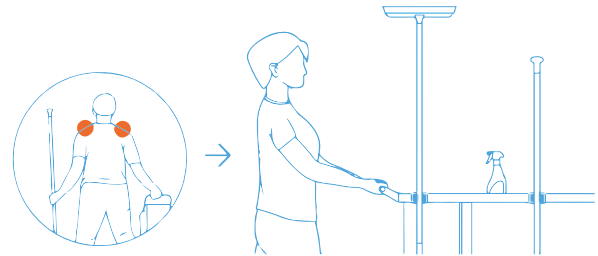

Comfortable / Smooth

Avoid harmful movements above the shoulders – secure tools at the right height and access them with a simple, one-handed motion (push in and pull-out feature).

Toolflex Motion holders rotate 360 degrees allowing users to precisely position tools on the cart.

Always at hand

With the right tools always at hand, users avoid bending and other harmful movements.

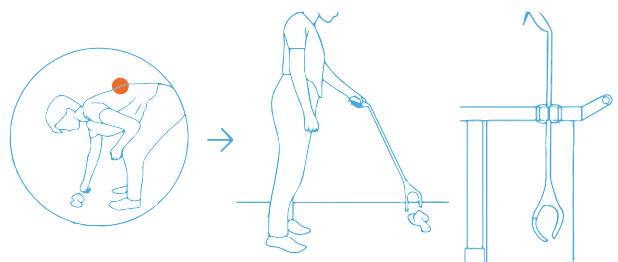

Efficient



If our cleaners spend 10 minutes per day searching for an item, we lose a lot of productive time. *

Inefficient

A messy work area is a source for delays, stress and safety hazards.

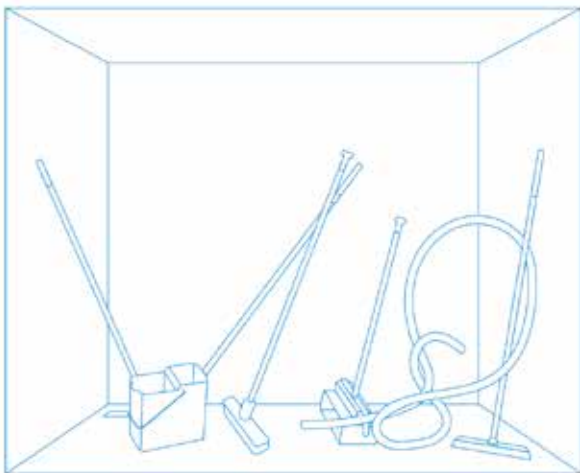

Efficient

Tools organized with everything in their place creates order from chaos to save time, reduce stress and promote safety.

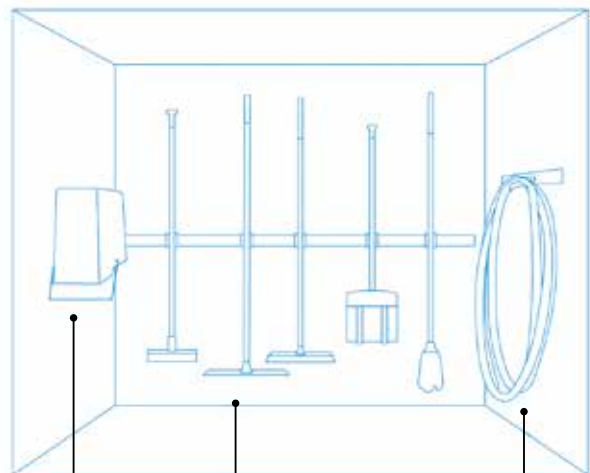

Bucket Holder,
page 12-15.



Hose Holder,
page 12-15.



Toolflex One,
page 8-9.

* Torbjörn Sporre, NT Service in Värnamo, Sweden, with 50 employed cleaners.

Hygienic

” We are required to segregate tools for workspaces, and there is no easier way than using different colours. It is difficult to make mistakes with this concept. *

Hygienic design

Innovative, hygienic design with smooth surfaces with extreme durability and performance.

Toolflex One is our NSF Certified system with one-size-fits-all, Click'n-go holders that can be adjusted, repositioned or removed for cleaning by hand, in dishwasher or autoclave.



Toolflex One, page 8-9.



Colour

- Available in 8 different colours
- HACCP compliant
- FDA approved raw materials
- NSF certified (Toolflex One)

Toolflex One Motion

Organisation on the Go

Toolflex One Motion is for professional users requiring tool storage on the move – ideal for the maintenance trolley or cleaning cart. Secure tools, easily and quickly, before moving to the next location. Save time by having the right tools always at hand.

Toolflex has become the standard on cleaning carts and trolleys in the professional cleaning industry.

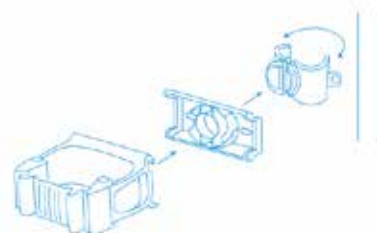

Toolflex One Motion includes Toolflex One holder, adapter and tube clamp.

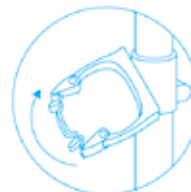

Unique tube clamp - 360° rotation.



Unique clamp function. Simple mounting with a standard Phillips screwdriver.

Toolflex One Motion is ideal for trolleys in various applications.

- Office cleaning
- Hotel cleaning
- Window cleaning
- Outdoor cleaning
- Staircase cleaning
- Waste collection

One Motion Holder for handles Ø 15-35



Tube clamp Ø	Art No
19 mm	570-19-1
20 mm	570-20-1
22 mm	570-22-1
23 mm	570-23-1
25 mm	570-25-1
28 mm	570-28-1

One Motion Cup



Tube clamp Ø	Art No
19 mm	591-19-1
20 mm	591-20-1
22 mm	591-22-1
23 mm	591-23-1
25 mm	591-25-1
28 mm	591-28-1

One Motion Hook



Tube clamp Ø	Art No
19 mm	534-19-1
20 mm	534-20-1
22 mm	534-22-1
23 mm	534-23-1
25 mm	534-25-1
28 mm	534-28-1

One Motion Tube Clamp



Tube clamp Ø	Art No
19 mm	540-19-1
20 mm	540-20-1
22 mm	540-22-1
23 mm	540-23-1
25 mm	540-25-1
28 mm	540-28-1



One Accessories

See page 12-15 for accessories for cleaning carts.

Tube diameter decision guide based on cleaning cart brands

If unsure, use the detachable measure at the back page.

Brand	mm Ø
Alpheios	20, 23
Gipeco	19
Hygienteknik (Activa)	19, 22
Hörby Bruk (Feja)	22, 25
IPC	22

Brand	mm Ø
KBM	22
Numatic	25
Rekola	19, 22
Röros	19, 22, 25
Tina Trolleys	22

Brand	mm Ø
VDM	22
Vermop	20, 22
Vikan	28
Vikur	22
Vileda	19, 22

Subject to changes.

Mounting instructions



Scan the QR code for download of mounting video or visit toolflex.com.

Toolflex One

The ultimate tool holder system

Engineered and designed to the strictest hygienic and performance requirements, Toolflex One is the ultimate, most versatile storage system that helps users effectively organize, efficiently store and quickly access a wide variety of tools of different sizes (Ø15–35 mm), shapes and contours.

Ø 15 mm

Ø 35 mm



One size fits all tools (Ø 15–35 mm).



Click 'n-go function

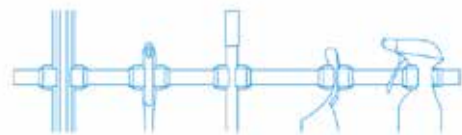

The unique and patented design assures that both small as well as large objects in different shapes are secured in a firm grip.

Toolflex One is ideal for

- Food and beverage processing
- Restaurant and hotels
- Convenience stores
- Commercial buildings
- Hospitals and elderly care



One Rail 54 cm with 3 x One Holder



Handle size	Art No
Ø 15-35 mm	5-3-X

94 cm Rail with 5 x One Holder



Handle size	Art No
Ø 15-35 mm	9-5-X

One Holder incl adapter, 2-pack



Handle size	Art No
Ø 15-35 mm	TF2-X



Mounted on rail or on wall with included adapter.

One Hook, 3-pack



Handle size	Art No
-	P01H-X

Mounted on rail.

Rail without holder



Length	Art No
54 cm	5-0-X
94 cm	9-0-X

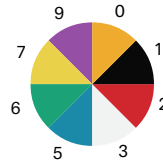

Colour coding

Available in 8 different colours.

X in Art No indicates chosen colour.
5-3-X (X = chosen colour)

Example: 5-3-5 (blue)

Hygiene and advantages



No stripes of dirt on the wall, the rail is mounted on distance supports.

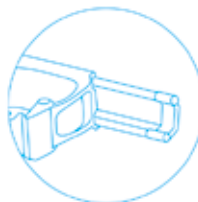

The hygienic design of the rail allows for dirt to just fall off or be dried off, no dirt traps.

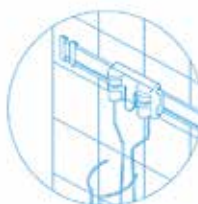

The hygienic rail is also used with Toolflex One Accessories, for example with holders for disinfection bottles, gloves and face masks, see pages 12-15.

Mounting instruction



Scan the QR code for download of mounting video or visit toolflex.com.

Toolflex Original Pro

Classic function

Toolflex Original Pro is our basic assortment of quality products suitable for professionals who want a simple, flexible storage solution. Available in four sizes. Holders can be mounted directly to the wall or onto the rail.



Direct mounting
or onto rail.



Slide function



Four sizes

Toolflex Original Pro is available in sizes that cover Ø 15-40 mm.

Small
Medium
Large
X-Large

Ø 15-20 mm
Ø 20-30 mm
Ø 25-35 mm
Ø 30-40 mm

Original Pro Small, 2-pack



Handle size	Art No
Ø 15-20 mm	602-X*

Original Pro Medium, 2-pack



Handle size	Art No
Ø 20-30 mm	612-X

Original Pro Large, 2-pack



Handle size	Art No
Ø 25-35 mm	622-X

Original Pro X-Large, 2-pack



Handle size	Art No
Ø 30-40 mm	632-X

Original Pro Rail 35/50/90 cm



Length	Art No
35 cm	3-0000-X
50 cm	5-0000-X
90 cm	9-0000-X

Original Pro 50 3L



Content	Art No
50 cm rail 3 x L 25-35 mm	5-0030-X

Original Pro 50 2M1XL



Content	Art No
50 cm rail 2 x M 20-30 mm 1 x XL 30-40 mm	5-0201-X

Original Pro 90 6L



Content	Art No
90 cm rail 6 x L 25-35 mm	9-0060-X

Original Pro 90 3M2XL



Content	Art No
90 cm rail 3 x M 20-30 mm 2 x XL 30-40 mm	9-0302-X

Original Pro Hook, 5-pack



Handle size	Art No
-	686-X

Mounted on rail.

Spare part kit for Original Pro



For holder	Art No
Small 15-20 mm	R602-X+6*
Medium 20-30 mm	R612-X+6
Large 25-25 mm	R622-X+6
X-Large 30-40 mm	R632-X+6

Content: 5 grippers and 10 pins.

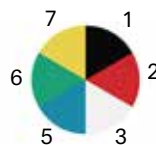

Colour coding

Available in 6 colours.

X in Art No indicates chosen colour.
602-X (X=chosen colour)

Example: 602-5 (blue)

Mounting instruction



Scan the QR code for download of mounting video or visit toolflex.com.

*Only available in black and white.

Toolflex One Accessories

More options

Toolflex One Accessories offers more storage options to your Toolflex System. With different holders that can easily be combined with Toolflex One Motion and Toolflex One*, you will find it easy to store, for example, bottles, disposable gloves, hoses and buckets.



Dustpan & Broom Holder,
see page 14.



Universal Holder,
see page 14.



Canister Holder,
see page 14.



Bottle Holder,
see page 14.



Glove Holder,
see page 14.

For Toolflex One Motion

Accessories for Toolflex One Motion – ideal for the maintenance trolley or cleaning cart. See page 14 for accessories for Toolflex One Motion.

*Accessories for Original Pro on request.

For Toolflex One Rail

Simple mounting on existing Toolflex One Rail or Toolflex One Utility Cart. See all One Accessories for Toolflex One on page 15.



Bottle Holder,
see page 15.



For wall

Accessories for Toolflex One can be mounted directly on wall with screws/anchors included in standard package. See page 15 for accessories for wall.



Canister Holder,
see page 15.

Something missing in our Toolflex One Accessories programme?

We have the possibility to produce customer-adapted storage solutions, based on different wire configurations.

Contact us at info@toolflex.com for more information.

One Accessories for mounting on cleaning cart

1. Holder

Choose between uncoated stainless steel or powder coated steel, available in black and white.

2. Adapter (included)

For mounting on cleaning cart (together with tube clamp).

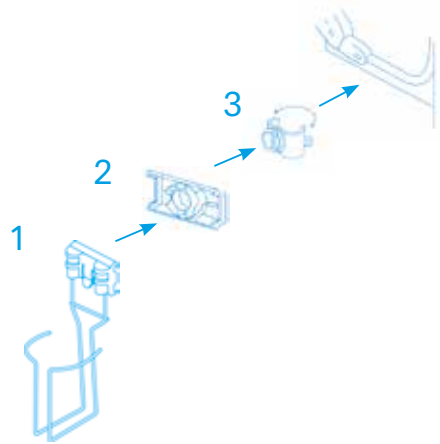

3. Tube clamp (included)

For mounting on cleaning cart. **XX** in Art No indicates chosen tube diameter.

3311-**XX**-1 (**XX**=chosen diameter)
Example: 3311-22-1 (22 mm)

Tube diameter decision guide, see page 7.



Scan the QR code for mounting video or visit toolflex.com.



Glove holder (max B130 x D65 mm)

Wire	Art No
Stainless steel	3310- XX -UC
Steel, black	3311- XX -1
Steel, white	3311- XX -3



Bottle holder (Ø 60-75 mm)

Wire	Art No
Steel, black	3321- XX -1
Steel, white	3321- XX -3



Canister holder (ca Ø 135 mm)

Wire	Art No
Steel, black	3331- XX -1
Steel, white	3331- XX -3



Face mask holder (max H120 x D100 mm)

Wire	Art No
Steel, black	3341- XX -1
Steel, white	3341- XX -3



Bucket holder

Wire	Art No
Stainless steel	3130- XX -UC
Steel, black	3131- XX -1
Steel, white	3131- XX -3



Universal holder

Wire	Art No
Stainless steel	3160- XX -UC
Steel, black	3161- XX -1
Steel, white	3161- XX -3



Hose holder

Wire	Art No
Stainless steel	3180- XX -UC
Steel, black	3181- XX -1
Steel, white	3181- XX -3



Dustpan & Broom holder

Wire	Art No
Steel, black	3191- XX -1
Steel, white	3191- XX -3

One Accessories for mounting on rail or wall

1. Holder

Choose between uncoated stainless steel or powder coated steel, available in black and white. Can be mounted on Toolflex One rail or Toolflex One Utility Cart.

2. Adapter (included)

For mounting on wall with included screws and anchors.

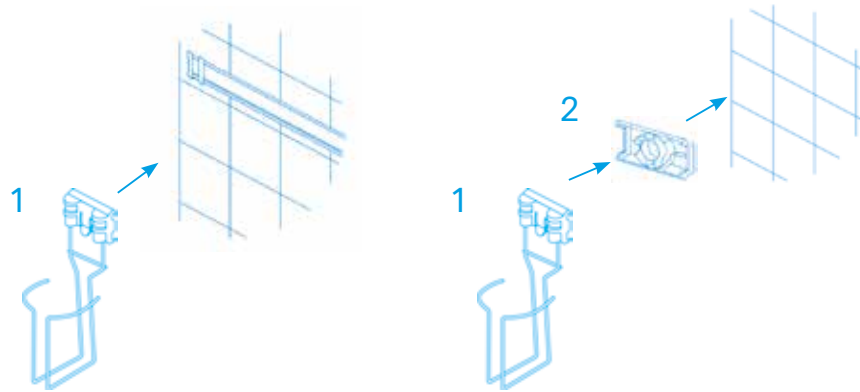

Glove holder (max B130 x D65 mm)

Wire	Art No
Stainless steel	3310-UC
Steel, black	3311-1
Steel, white	3311-3



Bottle holder (Ø 60-75 mm)

Wire	Art No
Steel, black	3321-1
Steel, white	3321-3



Canister holder (ca Ø 135 mm)

Wire	Art No
Steel, black	3331-1
Steel, white	3331-3



Face mask holder (max H120 x D100 mm)

Wire	Art No
Steel, black	3341-1
Steel, white	3341-3



Bucket holder

Wire	Art No
Stainless steel	3130-UC
Steel, black	3131-1
Steel, white	3131-3



Universal holder

Wire	Art No
Stainless steel	3160-UC
Steel, black	3161-1
Steel, white	3161-3



Hose holder

Wire	Art No
Stainless steel	3180-UC
Steel, black	3181-1
Steel, white	3181-3



Dustpan & Broom holder

Wire	Art No
Steel, black	3191-1
Steel, white	3191-3



Toolflex One Utility Cart, Single

Colour	Art No
Black	4000-1
White	4000-3



Toolflex One Utility Cart, Double

Colour	Art No
Black	4500-1
White	4500-3

The One Utility Cart is customisable to fit your needs. From mops, brooms and squeegees to hand-held brushes, our innovative Toolflex One Holder is our most versatile storage solution.

Expand your system with our interchangeable Hooks and Accessories to onboard buckets, spray bottles, hoses, electric cords, disposable gloves, face masks and other tools. With the patented Click'n-go feature, all of our accessories can be adjusted or repositioned on the fly.

Easy mounting/dismantling of holders with Click'n-go function.

Comfortable, ergonomic handles on both sides.



Robust tray for buckets, mop boxes and other accessories.

Easy rolling wheels, two with brakes.

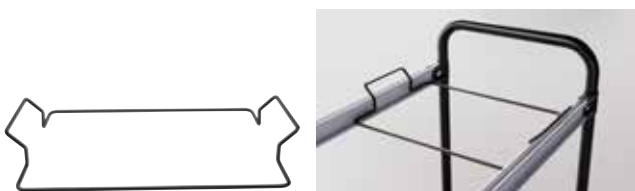

Trash Bag Holder for One Utility Cart, Double

Colour	Art No
Black	3192-1

Single



Scan the QR code for mounting video or visit toolflex.com.

Double



Toolflex One Utility Cart is ideal for

- Cleaning companies
- Shools and kindergartens
- Hotels and guest houses
- Hospitals and elderly care
- Restaurants and food industry
- Supermarkets and stores
- Offices and administration
- Other speciality applications

Made in Sweden

A sustainable storage system

Toolflex was founded in 1983, designed and produced in Sweden. Sustainability is a pillar of everything we do – from choosing high quality recyclable materials to the endeavor to work with sub-contractors located close to our factory in Småland, Sweden.

Distribution in over 40 countries

With over 50 million installed units since start, the Toolflex brand is offered and distributed to over 40 countries.

Please visit our website or contact us for additional information. Our full list of retailers and distributor partners can be found on our website.

www.toolflex.com

info@toolflex.com





Tear off and save!
Use this tape measure to find out the diameter of a cleaning
cart tube or a tool handle.



Everything in its place

Toolflex Professional System is a Swedish quality product from Delex Teknik AB. Delex is certified according to ISO 9001 and ISO 14001, which guarantees that all products from Delex are manufactured with a consistently high quality and with utmost consideration on environmental considerations.

Delex Teknik AB
Forsnäsavägen 11
SE-331 71 Forsheda
+46 (0)370-37 46 00

info@toolflex.com

www.toolflex.com